

RoHS Compliant

Mechanical:

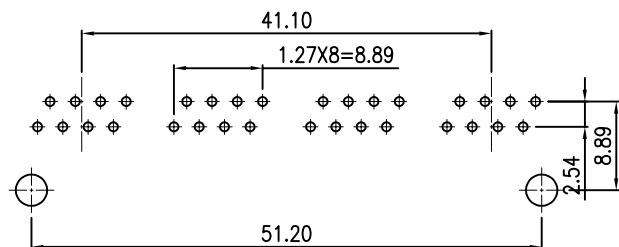

RECOMMENDED P.C.B LAYOUT(PCB THICKNESS: 1.6mm)  
COMPONENT SIDE VIEW(TOLERANCE: ±0.05mm)

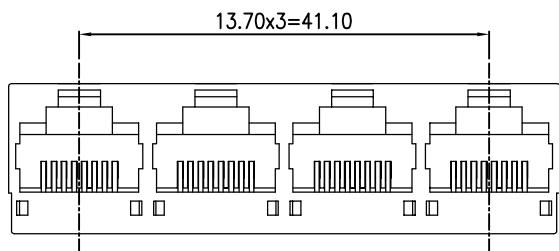
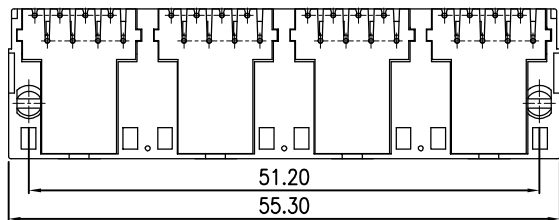
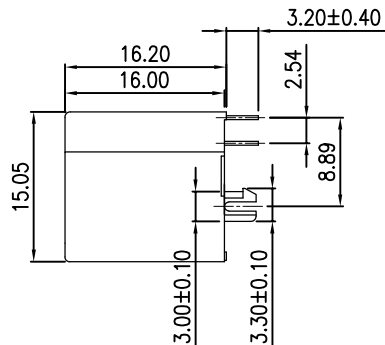

REV	MODIFICATION	DATE	DRAW	APPROVE

NOTES:

- RJ ELECTRICAL CHARACTERISTICS:
  - VOLTAGE : 125V AC RMS
  - CURRENT RATING : 1.5 AMP.
  - CONTACT RESISTANCE : 30mΩ MAX.
  - INSULATION RESISTANCE : 500MΩ MIN. @ 500 VDC
  - DIELECTRIC VOLTAGE : 1000V AC RMS 50Hz or 60Hz, 1MIN.
- MECHANICAL:
  - HOUSING&INSERT MATERIAL : PBT, UL94V-0 YELLOW 114C
  - CONTACT MATERIAL : DIAMETER 0.45mm PHOSPHOR BRONZE GOLD PLATING OVER NICKEL.
  - MATING/UNMATING FORCE : 2.2KG.F MAX.
  - RETENTION STRENGTH : 7.7KG.F MIN BETWEEN JACK AND PLUG.
  - OPERATING LIFE : 600 CYCLES MIN.
- ENVIRONMENTAL:
  - STORAGE : -40°C ~ +85°C
  - OPERATION : -40°C ~ +85°C

QC : Inspection Item	DIMENSION IN mm [Inch]		ZhenDeng Electronics Co.,Ltd			
	TOLERANCE UNLESS OTHERWISE SPECIFIED		TITLE			
	.X± 0.38	X.*± 2.0*	RJ45 JACK 1X4			
	.XX± 0.25	.X*± 1.0*	DRAWING NUMBER			
.XXX± 0.10		DRAWING_NO.				
APPROVE	CHECK	DRAW	PROJ.	SHEET X OF Y		
		KONGLEI 2020,04,30		SCALE	RATIO	
			SIZE	A3	REV A	